



ARTIST'S IMPRESSION: INPATIENT AND AMBULATORY CARE BALCONIES

Caring for Eurobodalla communities now and into the future

The NSW Government has announced \$260 million to build a sustainable, modern and purpose-built facility to support the needs of the entire Eurobodalla Shire from Narooma to Batemans Bay.

Using the latest technology and models of care, the new hospital will deliver health services closer to home. The new hospital will:

- Provide care in one location, improving accessibility to a range of health services across the region.
- Help attract and retain high quality staff in a modern working environment that supports excellence in clinical practice and education.
- Provide positive economic and social benefits within the Eurobodalla and surrounding communities through employment, skills development and local expenditure, during construction and into operations.
- Provide expansion zones for future health, education, training and research facilities.
- Deliver the supporting infrastructure required for the new hospital, including outdoor green spaces, campus roads and car parking, external road connections, utilities connections, and other site infrastructure.

The new hospital will be larger than both Moruya and Batemans Bay hospitals combined.

The new Eurobodalla Regional Hospital will provide:



An emergency department



A day-stay surgical unit



Surgical and operating theatres



Ambulatory care for community and outpatient services



An eight bed Intensive Care Unit (ICU) / Close Observation Unit (COU)



Paediatric and maternity services – including inpatient beds



Dedicated medical, surgical and rehab beds



Increased capacity for chemotherapy treatments



Expanded medical imaging, including MRI



Mental health beds for short term admission



Enhanced education and training facilities

The facility is designed with the capacity to grow as demand for services change.

Strengthening the region's Coastal Network

The Coastal Network brings together healthcare services and diverse populations across the South Coast region and includes the Eurobodalla and Bega Valley municipalities and tourist destinations such as Batemans Bay, Merimbula, and Eden. The Network's services cater for the health needs of its residents and the thousands of tourists who visit each year.

The Coastal Network has four hospitals that are supported by community health services at Batemans Bay, Narooma, Moruya, Bega, Pambula and Eden. It also has inpatient and outpatient services, including obstetrics, surgery, acute inpatient, mental health, paediatrics, oncology, renal and sub-acute rehabilitation.

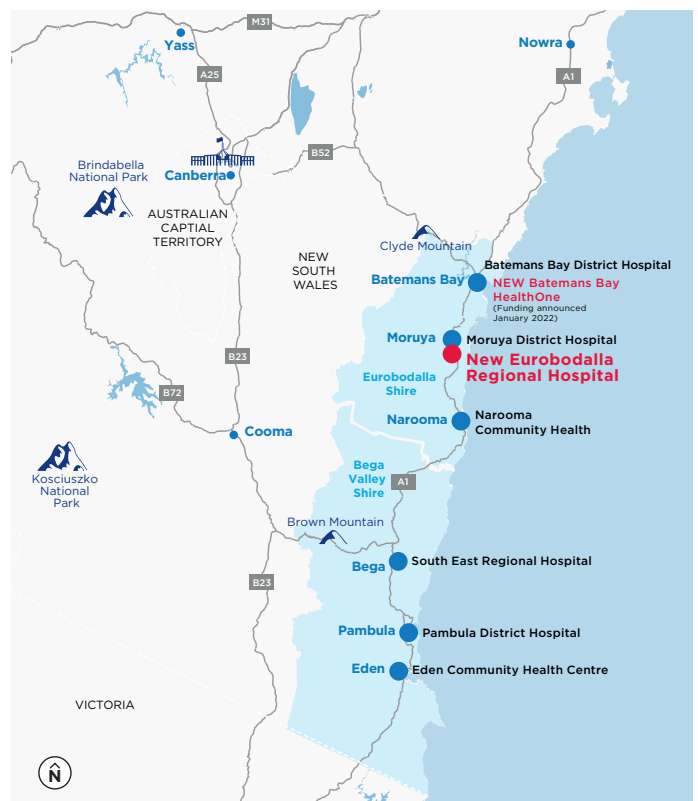

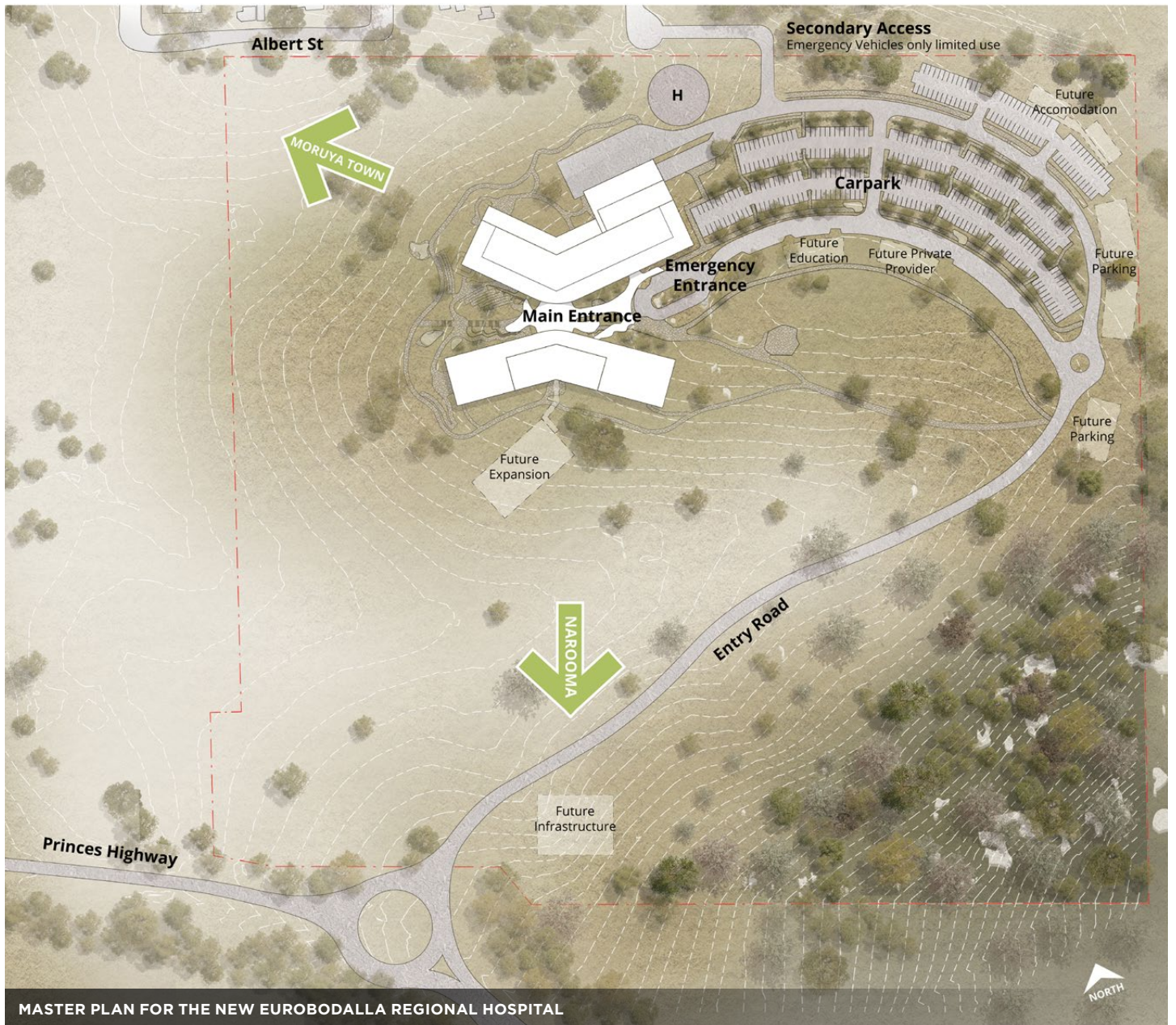

MASTER PLAN FOR THE NEW EUROBODALLA REGIONAL HOSPITAL

The New Eurobodalla Regional Hospital site

The location for the new Eurobodalla Regional Hospital was announced in December 2020. The site for the new hospital was selected following consultation with community, consumers, local Aboriginal groups, Transport for NSW and the Eurobodalla Shire Council.

The site has been evaluated against a range of assessment criteria including current and projected population growth areas, flood and bushfire zones, capacity for future expansion, transport, and access to and from key infrastructure such as Moruya Airport and the planned Moruya Bypass.

For updates on the Moruya Bypass project please visit the project website:

www.rms.nsw.gov.au/projects/moruya-bypass

Take a closer look at the master plan

The master plan and early designs for the new hospital were revealed in December 2021. The key purpose of master planning is to develop a framework for how key clinical connections and requirements can be supported with different types of infrastructure, and how this infrastructure can be located and connected to existing and new health networks, as well as supporting infrastructure such as transport and utilities. It addresses how people will get to and from the hospital and how the hospital works as a place.

The master plan shows how the hospital is situated on the site and considers how the hospital will expand to continue to provide high quality health services well into the future. The campus master plan for the new hospital has been developed in consultation with local and state government agencies, clinicians, operational staff, and the community.

Features of the new hospital and supporting infrastructure

The master plan guides the final hospital design, including the location of infrastructure to support clinical services such as the emergency department, operating theatres and medical imaging, as well as access requirements to the new hospital.

An on-grade helipad

The new hospital includes a helipad to transport patients requiring specialist care to hospitals in Sydney and Canberra. A number of locations for the helipad were investigated as part of the master planning process, with an area close to the emergency department identified as the preferred location. The assessment considered the site's topography, flood zone, asset protection zones (bushfire), biodiversity zones and cultural heritage areas as well as aviation requirements to ensure safe take-off and landing, and also ensure ready access to critical emergency services.

Hospital site entrance

The hospital site entrance for all public and hospital vehicles, including ambulances will be via the Princes Highway.

Within the site, there will be a separate entry to the emergency department to ensure patients requiring emergency care can enter as quickly as possible without having to use the main hospital entrance.

Secondary access road for emergency vehicles if Princes Highway is impassable

There will be a secondary access road for emergency vehicles off Caswell Street. This access will be used only in the event the Princes Highway is obstructed and emergency vehicles are unable to access the hospital main entry (for example a traffic incident). It will not be used for general public or staff access.

Construction access to support enabling works

During the hospital main works construction, primary construction access will be from the Princes Highway.

Before construction of the main hospital building commences, temporary and limited access from Albert Street will be required while primary access from the Princes Highway is being established. Once primary access is established, all access will be from the Princes Highway.

We recognise that construction work has the potential to affect our neighbours and the local community. We will continue to consult with the community as the project progresses to reduce the impact of construction on our neighbours.

Concept design

The concept designs are the first step in bringing the design elements of the hospital to life. The concept design is a 'high-level' design which shows the relationship between the clinical functions, services, buildings and other facilities in the hospital.

The concept design diagram provides an early, indicative representation of the location, size and scale of key clinical functions. During the concept design phase, Project User Groups and key stakeholders will continue to be consulted, and where necessary adjustments can be made.

To view the concept designs visit: www.eurobodallahs.health.nsw.gov.au

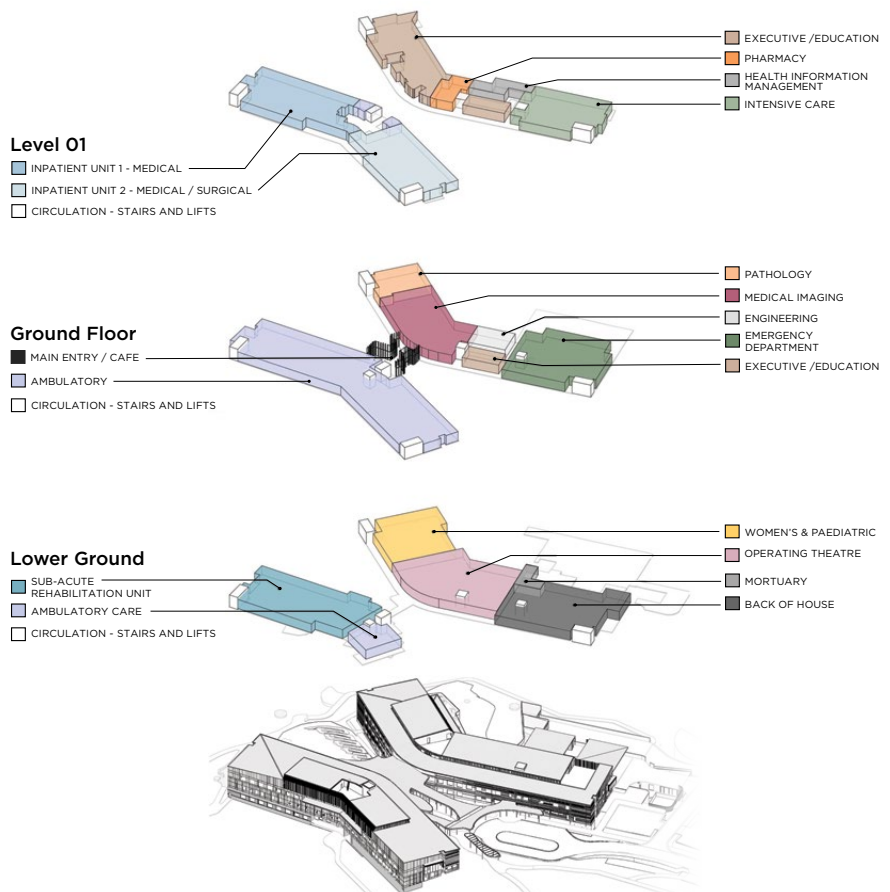

How to build a hospital

There are three distinct phases:

- planning
- design
- delivery

Each development is tailored to a community's unique needs.

Visit the Health Infrastructure website for more information:

www.hinfra.health.nsw.gov.au/our-business/how-to-build-a-hospital



Where are we now?

We are well underway into the five year process of planning and delivering the new Eurobodalla Regional Hospital and significant progress has been made following the announcement of funding for the new hospital in May 2020.

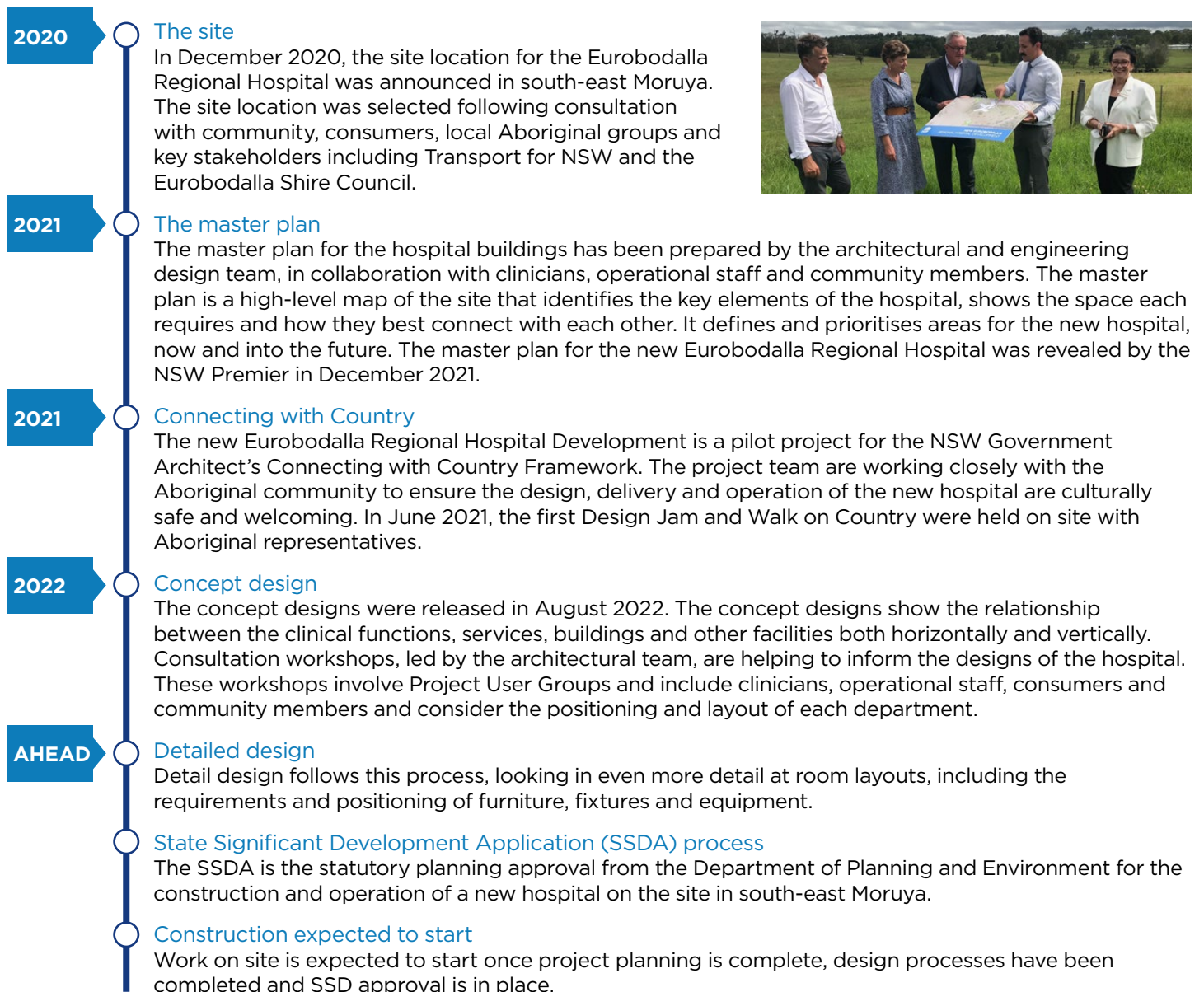

Connecting with Country

Closer connections with Country are shaping and informing the new hospital to create a place of healing and wellbeing for all. The new hospital development is a pilot project for the NSW Government Architect's 'Connecting with Country' framework. In addition to the existing community consultation process, Connecting with Country seeks local Aboriginal knowledge in design and in strategies to reduce the impacts of natural events such as fire, drought and flooding through sustainable land and water use practices. Connecting with Country also encompasses the use of local language, cultural health, wellbeing, and healing practices, focused on creating a culturally welcoming and safe facility for all.

Before any work is undertaken on the site, an archaeological salvage process will be carried out to identify any Aboriginal objects or artefacts. The archaeologists work closely with the Aboriginal community as well as the Cobowra Local Aboriginal Land Council and other Registered Aboriginal Parties to undertake this work.

Local flora and fauna

We are committed to protecting local flora and fauna on the new hospital site. The team engaged experts to carry out day and night surveys of trees, plants and vegetation located on or close to the perimeter of the site. This survey identified plants and vegetation present as well as wildlife and habitat species present.

The information gathered will form part of the Biodiversity Management Plan (BMP) for the project. The BMP is one of the guiding set of documents which informs how the site is managed during construction, and once the hospital opens, to ensure native flora and fauna are looked after.

How can you be involved?

Health professionals, consumers, and communities across the Eurobodalla region all have an important role in shaping key aspects of the new hospital.

There are currently 17 Project User Groups comprising of approximately 170 nominated health service staff, clinical leads and hospital consumers who inform the design of physical spaces with recommendations of how they will work in the future.

Consultation with staff, stakeholders and community looks at the services to be provided and activities to be performed; where and how the hospital will work and interact with other units, as well as shaping key aspects of the hospital amenity and facilities. To find out more or get involved email:

HI-EurobodallaHospital@health.nsw.gov.au



ARTIST'S IMPRESSION: WALAWANNI AND MEETING PLACE

What's in a name?

Local languages are being used throughout the new Eurobodalla Regional Hospital to support health, wellbeing and ensure the hospital is a welcoming space for everyone.

Walawaani: translated into the local Dhurga language, Walawaani means safe journey.

Meeting Place: is a culturally significant site for Aboriginal people. It is a place where people meet, gather around and have conversations.

State Significant Development Application (SSDA)

All development applications for significant projects in NSW have to go through a comprehensive assessment process undertaken by the Department of Planning and Environment. This process is called a State Significant Development Application (SSDA).

There are many steps in the SSDA planning process, including opportunities for you to have your say on the hospital plans.

The first step in the process is a request for the Secretary's Environmental Assessment Requirements (SEARs), which identifies what must go in the environmental impact statement.

You can review the SEARs and other project documentation as it becomes available on the Major Projects website of the NSW Department of Planning, Industry and Environment at: majorprojects.planning.nsw.gov.au.

FOR MORE INFORMATION ABOUT THE DEVELOPMENT:

Phone: 1300 391 949 | Email: HI-EurobodallaHospital@health.nsw.gov.au

Web: eurobodallahs.health.nsw.gov.au